



2 BEDROOM HOME

A STYLISH AND PRACTICAL HOME FEATURING:

- > Lounge with French doors leading to garden
- > Modern kitchen
- > Ground floor cloakroom
- > Two double bedrooms
- > Contemporary bathroom
- > Under stairs storage

THE FARNDALE

BEAL HOMES
a total lifestyle concept

THE FARNDALE

2 BEDROOM HOME

THE BEAL DIFFERENCE:

- > Ability to change internal layout - creating a bespoke house*
- > Kitchen design service to customise the layout to suit you*
- > Choice of designer internal fittings & fixtures
- > Choice of fire and surround
- > Choice of contemporary ceramic tiling
- > Security alarm system
- > 'Low maintenance' windows, fascias and soffits
- > 6ft privacy fencing to garden
- > Patio area to French doors
- > Extensive list of 'fitted as standard' items

GROUND FLOOR

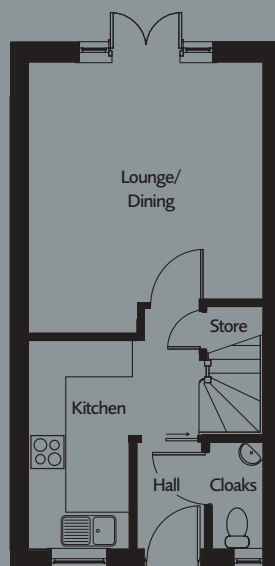

LOUNGE/DINING 12'11" (3.95m) x 14'4" (4.39m max)

KITCHEN 9'8" (2.94m max) x 10'11" (3.33m)

CLOAKS 3' (0.91m) x 5'8" (1.72m)

FIRST FLOOR

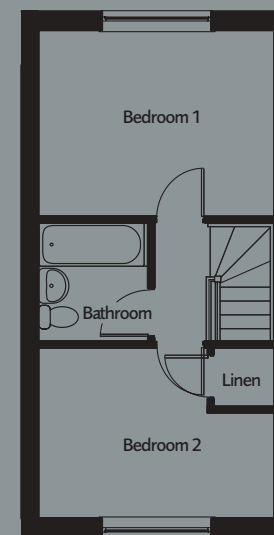

BEDROOM 1 12'11" (3.95m) x 9'9" (2.98m)

BEDROOM 2 12'11" (3.95m) x 8'11" (2.73m max)

BATHROOM 5'8" (1.74m) x 6'3" (1.91m)

Important Notice

These particulars are for illustration only. We operate a policy of continuous product development and individual features such as windows, garages and elevational treatments may vary from time to time. Consequently these particulars should be treated as general guidance only and cannot be relied upon as accurately describing any of the Specified Matters prescribed by an Order made under the Property Misdescription Act 1991. Nor do they constitute a contract, part of a contract or warranty. *Subject to stage of construction at time of reservation, and building regulations where applicable.

BEAL HOMES

a total lifestyle concept

Holderness House, Tower House Lane, Hedon Road, Kingston-Upon-Hull, HU12 8EE

Tel: 01482 899114 Fax: 01482 890902 Web: www.beal-homes.co.uk